

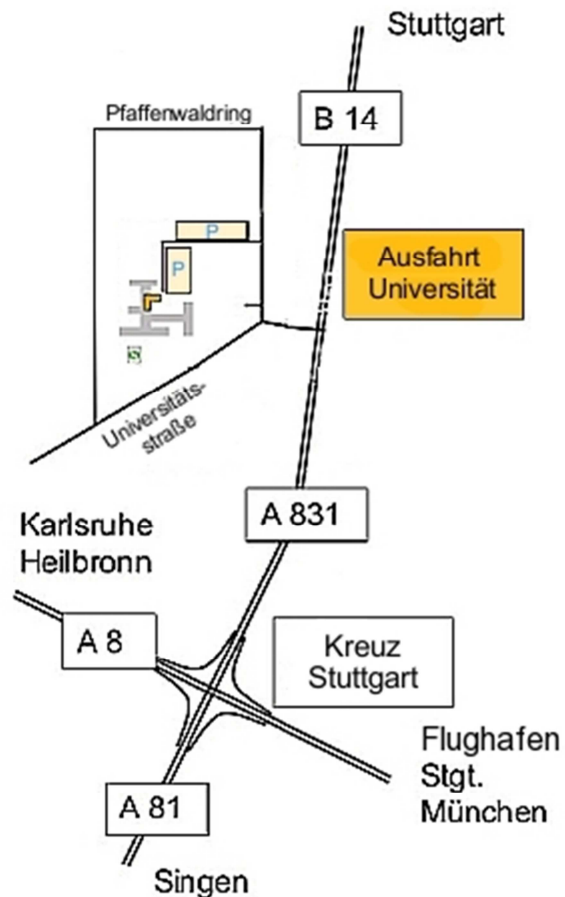

## Institut für Technische Optik - Travel Directions

### 1. Region



#### Arrival by car:

- Leave A 8 at the motorway intersection Stuttgart in the direction of Vaihingen A 831.
- Leave A 831 at the junction „Universität“, afterwards get in left lane (in front of the traffic light)
- Turn left at the traffic light, cross A 381, turn right into Pfaffenwaldring after a lay-by.
- Turn left when you have the second possibility ( follow road signs „11“, „13“ and „15“; do **not** follow „7“ and „9“, afterwards turn again left to the parking lot.
- Use the delivery entrance to get into building no.9 (IWZ = Ingenieurwissenschaftliches Zentrum) and go upstairs or use the elevator.
- Arriving on the first floor you enter the premises of the ITO. The secretariat is located in the first corridor that is on the left..

#### Arrival by train or tram:

- About every 10 min a tram is moving off main station (S1, S2 or S3) towards „Herrenberg“, „Flughafen/Messe“, „Filderstadt“ or „Vaihingen“.
- The tram-stop „Universität“ (not „Vaihingen“) is situated on the campus of the University of Stuttgart. The exit of the elevator of the tram is exactly vis-à-vis the entrance of the building Pfaffenwaldring 9.
- After entering the building you turn right into the direction of the cafeteria. In front of the cafeteria you turn left and walk into the corridor. Use the elevator or stairs to reach the ITO on the first floor.

## 2. ITO on the Campus



Daten von OpenStreetMap  - Veröffentlicht unter CC-BY-SA 2.0

## 3. The institute in detail

zum Parkplatz 

Institut für Technische Optik  
Pfaffenwaldring 9  
1. Stock

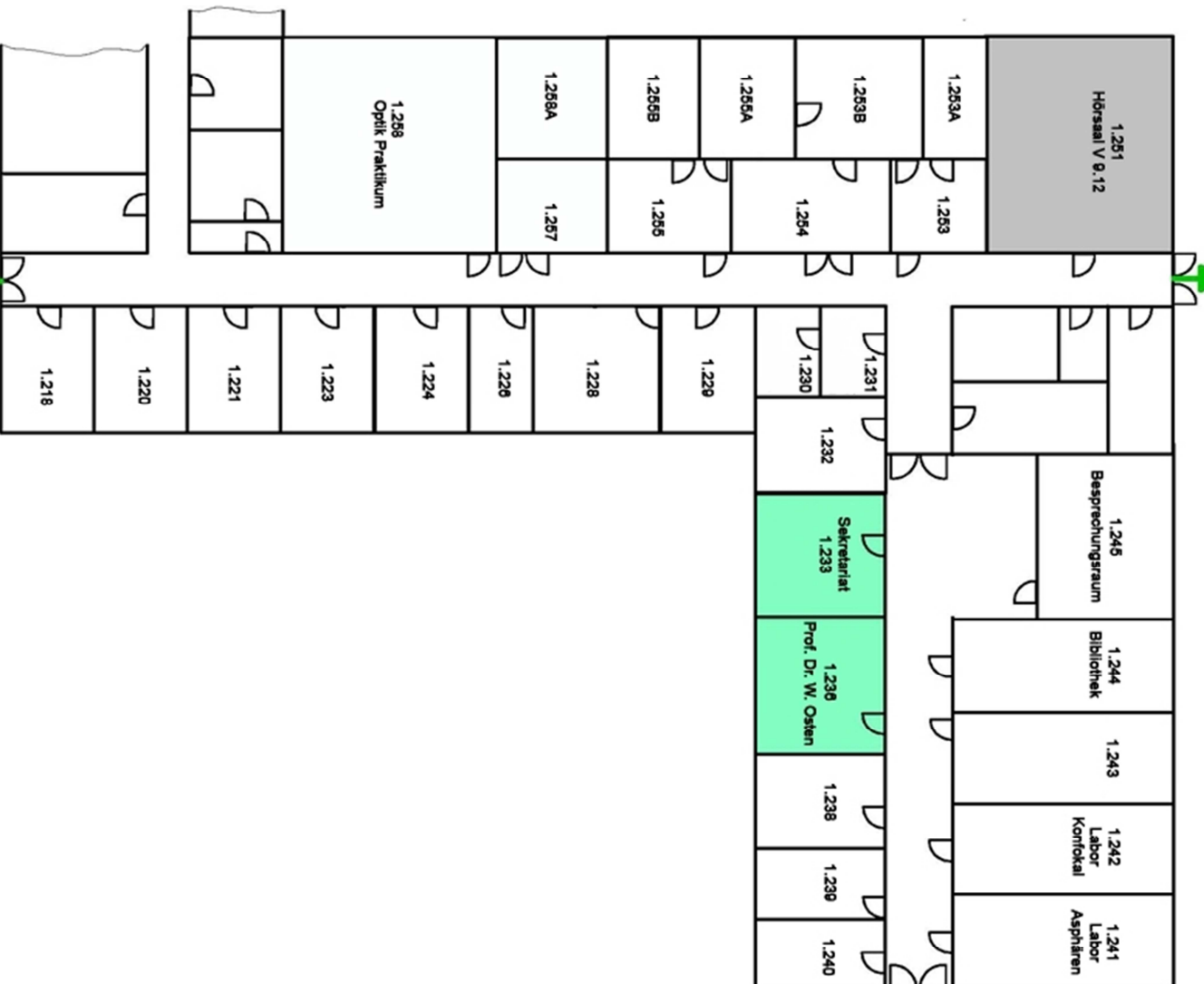

zur S-Bahnstation